



TERRAIN TM3 Membrane Black

COVERAGE

Description	Pack Size	Coverage	Product Code
TM3 NON-MESH	2 m x 20 m	40 m ²	1304WYK



DESCRIPTION

Terrain TM3 Non-Mesh Membrane is a 3 mm studded membrane, suitable for Type C waterproofing or damp-proofing and delivering a grade 3 environment to BS8102:2009 and NHBC Chapter 5.4.

USES

Walls, Floors, Vaults, Tunnels, Above and below ground level, Waterproofing applications, and Damp-proofing applications.

ADVANTAGES

- Fast track flooring applications (damp barrier)
- Part of a type C cavity drain membrane system in line with BS8102:2009.
- Quick to install - minimal preparation needed to wall and floor surfaces.
- Easy to fold around windows and doors.
- Easily cut down using a sharp blade.
- No drying out process - redecoration can occur immediately.
- Little or no damage to the existing structure.
- Low and high temperature tolerance.
- Creates a dry, habitable living space in areas previously suffering from damp/wet conditions.
- Waterproof, salt inhibiting, root and contaminate resistant.

APPLICATION

With studs facing the wall, fixing is carried out using Terrain TM Plaster Plugs or Terrain TM Brick Plugs.

1. We recommend an application of Kingfisher Storm Seal to the concrete walls and slab, before an application of TM8, to prevent lime efflorescence and dusting, which can block perimeter drainage channels.

2. Drill a hole through the centre of the stud. Take care when drilling holes to avoid excessive masonry dust from falling into the cavity.

Manufacturers to the building industry

Specialist Coatings



Sealants

Roof Coatings



Paving Sealers

Timber Treatments

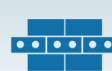

Damp Proofing

Membranes



Basement Waterproofing

3. Place the chosen plug (with seal for all underground waterproofing applications) into the hole and drive the fixing home with a rubber mallet or club hammer.
4. We would suggest that spacing between plug fixings should be no greater than 600 mm, to ensure a tight fix to the wall. However, this may vary depending on the exact batten/board size and site conditions may dictate otherwise.
5. Seal the membrane at the flanges (a band of membrane running along the edge where no studs are present) with Terrain Tape.
6. Stud-to-stud joints are overlapped by at least two rows (three in very wet conditions) and the flat area is then sealed with Terrain Rope.
7. Ensure flanges run vertically on walls and are positioned in front of the preceding width of membrane. In the case of horizontal joints, the lower sheet is positioned to the front.
8. Where there is or could be severe water ingress, a membrane with a greater stud height should be considered.

Vaulted Ceilings:

These can be successfully lined using Terrain TM3, taking care to seal all mitred joints with Terrain tape/Rope/Overseal Tape.

Above Ground:

TM3 Membrane should finish at solid floor and ceiling junctions using profile strips.

CONDITIONS & LIMITATIONS

Flat soffits below ground should never be lined with Terrain TM3 Membrane as it requires a minimum slope of 10%. Floor Applications:

TM3 Membrane is rolled out (studs down) and joints sealed as in wall applications. No fixings should be used.

STUD FRAME FINISHING

When using this finishing method, Terrain Brick Plugs should be applied in a vertical line, roughly corresponding to the stud locations and battens (minimum of 25 x 38mm). Fix the stud frame to the plugs using No. 10 screws (5 mm). If the plugs cannot be applied in a straight line, 'Gyproc' brackets can be used to hold the battens in place. ensure the screw depth does not perforate the TM3 Membrane.

FLOOR FINISHING

TM3 Membrane may be overlaid with closed cell insulation before laying T&G flooring, ensuring a 10 mm expansion joint all around. Alternatively, a conventional 65 mm of sand and cement screed can be laid, although site conditions may vary, therefore if doubt exists, please contact the Kingfisher Technical Department. Normal decorating materials can be used as soon as the floor, screed or plaster finishes are dry. While applying, ensure atmospheric moisture levels are below 70% RH. Impermeable floor finishes should not be laid until screed moisture content is below 75% RH.

Manufacturers to the building industry

Specialist Coatings



Sealants

Roof Coatings



Paving Sealers

Timber Treatments

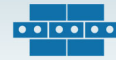

Damp Proofing

Membranes



Basement Waterproofing

AFTERCARE

Terrain TM3 membranes provide a dry, warm, and habitable living space in basements and other areas suffering from chronically damp conditions. However, it is equally important that areas which lack natural ventilation are provided with adequate means of condensation control, especially in wet areas such as kitchens, bathrooms etc. This is best achieved through the provision of an effective mechanical ventilation system.

Please consult the Kingfisher Technical Department for further advice. This product is also available with a high-performance bonded mesh for direct plaster finishes.

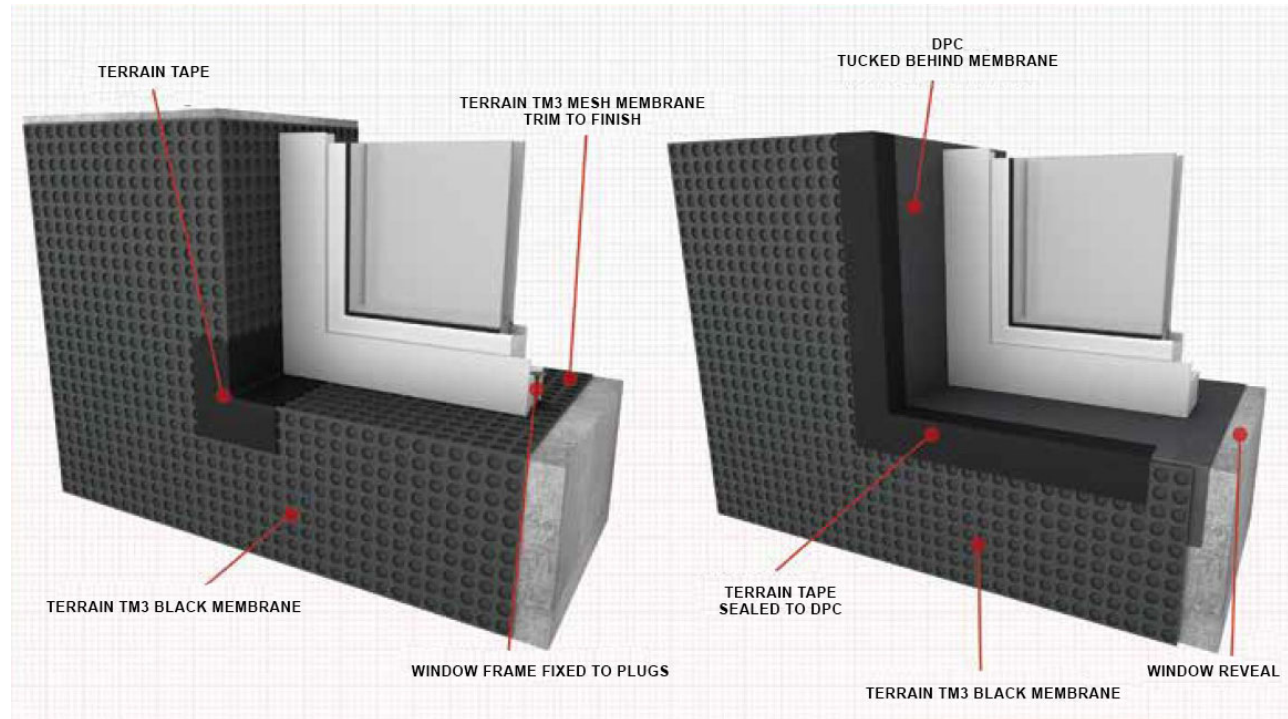

Technical Data

Material
Unit Weight
Sheet Thickness
Stud Height
Colour
Water tightness 60 kPa; 24h
Working Temperature
Softening Temperature
Tensile Strength MD
Tensile Strength CD
Resistance to Static Loading
Compressive Strength
Reaction to Fire
Type of Application Type
Life Expectancy

Result

HDPE
0.5 Kg/m²
0.6 mm
3 mm
Black
Pass
-50°C to +80°C
126°C
416 N
488 N
>20 Kg
250 kN
Class F
V

Lifetime of Structure

Test Standards

N/A
N/A
N/A
N/A
N/A
EN 1928
N/A
N/A
BS 12311-2
BS 12311-2
BS 12730
BS EN ISO 25619-2
BS EN 13501-1
N/A

Manufacturers to the building industry

Specialist Coatings



Sealants

Roof Coatings



Paving Sealers

Timber Treatments

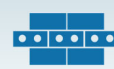

Damp Proofing

Membranes



Basement Waterproofing

STORAGE & SHELF LIFE

Store in an upright position, under cover and away from high temperatures and open flames. Shelf life is the lifetime of the structure, when stored and installed in line with the datasheet recommendations.

HEALTH & SAFETY

No specific hazards are likely to arise while using any Terrain Waterproofing Membranes or ancillaries; neither are classified as hazardous in respect to CHIP II Regulations 1999. However, general precaution should be exercised in the use of drills etc. taking particular note of the special risks associated with working in confined spaces (basements) with restricted access/egress. Kingfisher Building Products always advise the use of appropriate PPE, including gloves, hard hat, goggles, high visibility jackets and steel toe cap boots. For further information and advice.

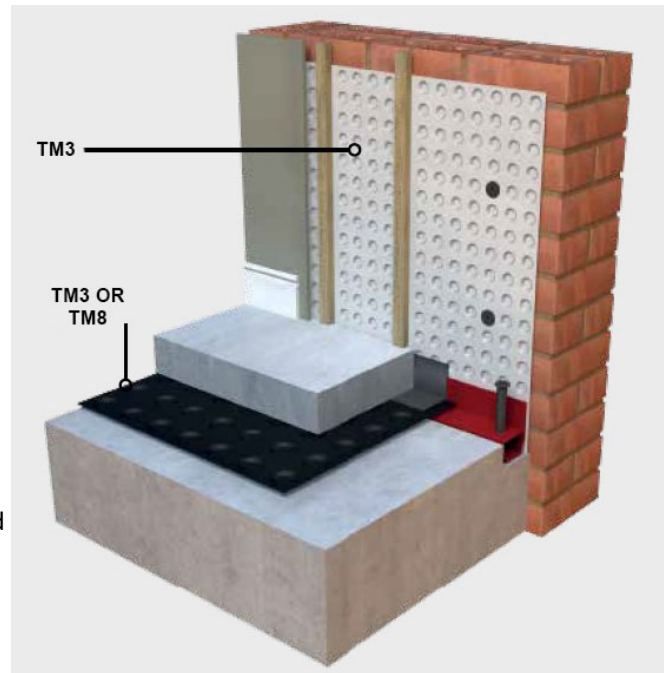

Please contact the Kingfisher Technical Department and consult the Safety Data Sheet, which is available upon request. CALL OUR TECHNICAL SUPPORT TEAM ON 01229 869 100

The information given in this product data sheet is given in good faith, based on current knowledge and experience. It relates only to the specific material designated and may not be valid for such material used in combination with any other materials or in any process. Such information is to the best of the company's knowledge and belief, accurate as of the date indicated.

All recommendations are made without warranty or guarantee, as to accuracy, reliability, or completeness since the conditions of use are beyond our control. It is the user's responsibility to satisfy themselves as to the suitability and application of such information for their own use.